

Warranty card included

MODEL: A650 Slim Smart Washer 3

Installation and User Manual

- Thank you for purchasing the BIDET. Please read through the manual carefully for appropriate use of the product.
- After you read through the manual, keep it at a proper place for further reference.

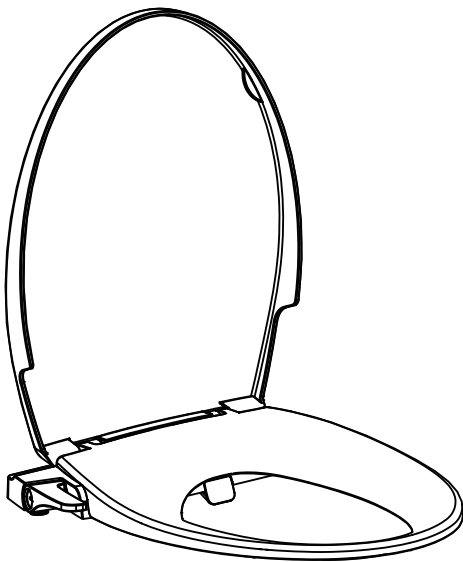

A650

1 Names of Parts 1-2

2 Installation	3
• Precautions	3
• Installation	3
Pre-installation	3
Installation Procedure	4-5
Connecting Water Hose	6
Disassembling water hose	6

3 Operation	7
Bidet	7
Wash	7
Stop	7

4 Clean and Dismantlement 8

5 Product Maintenance	9
6 Self Diagnosis and Specifications	8
Self Diagnosis and Trouble Shooting	10
Specifications	10
Warranty	

1 Names of parts

Product

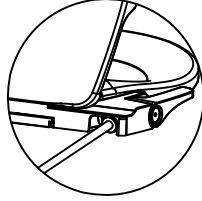
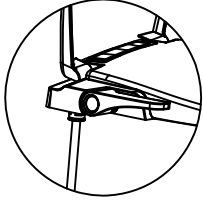

Water bottom inlet & back inlet option

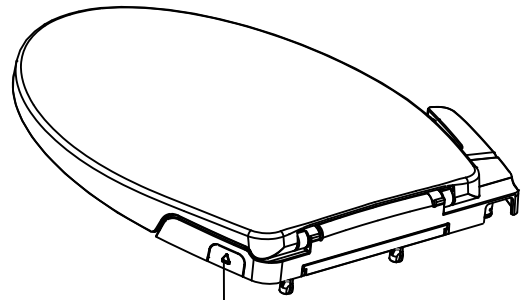

Quick release button

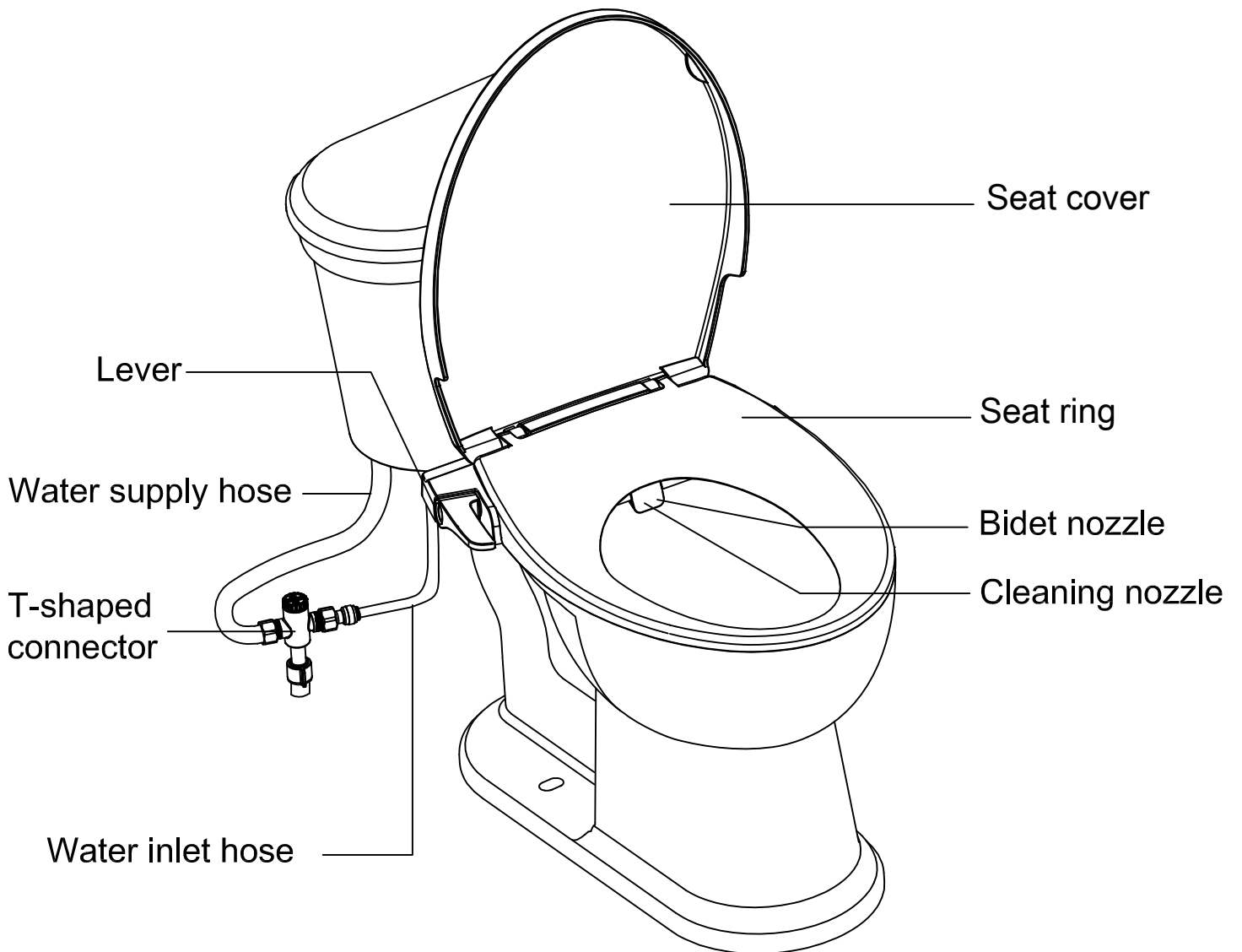

■ Components

1.Main body

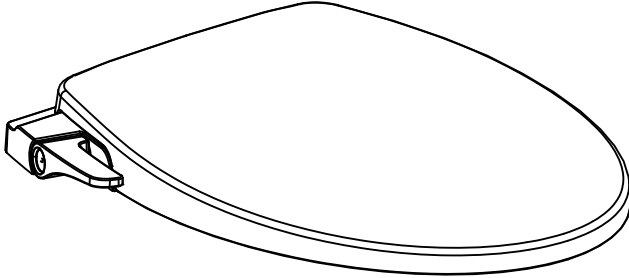

2.Fixing Components

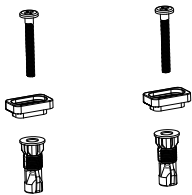

Bolts(2)

Sliding plates(2)

Separating expansive nuts(2)

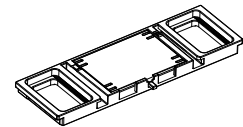

Adjustable panel

3.T-shaped connector

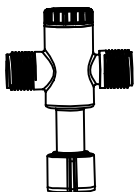

4.Water inlet hose

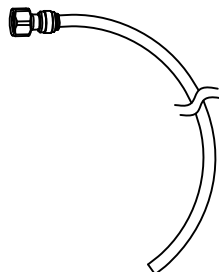

5.Installation and User Manual

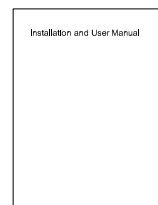

2 Installation

Please make sure you read the instructions carefully and install it properly.

■ Cautions

1. The water pressure limit is from 0.07 to 0.6 MPa(10-87PSI). Please use as instructed.
2. The water shut-off valve should be near to where the product can be installed and dismantled.

■ Product Installation Procedures

■ Pre-installation

1. Insert the connecting bolts in adjusting pieces.

As figure, insert the connecting bolts in the holes of adjusting pieces.

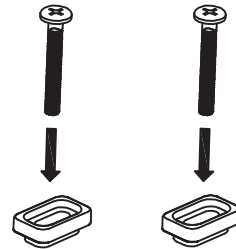

2. Press the button, take out the adjustable panel.

As figure, press the button, take out the adjustable panel.

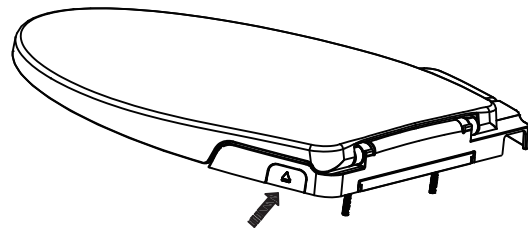

3. Insert connecting bolts with adjusting pieces in the adjustable panel.

As figure, insert the connecting bolts in the holes of adjusting pieces, which are in the holes of the adjustable panel.

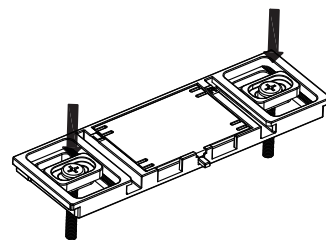

■ Installation Procedures

1.As figure, install the nuts to the bolts.

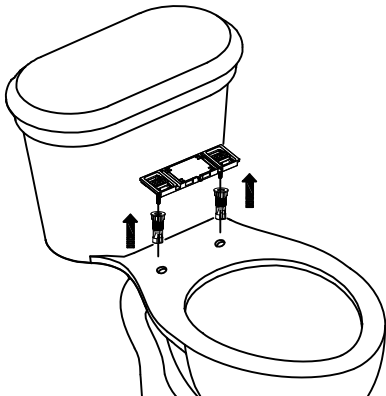

2.As figure, take the adaptable panel to the holes of the ceramic. Adjust position for connecting bolts and adjusting pieces, make the connecting bolts aim at according to expansive nuts.

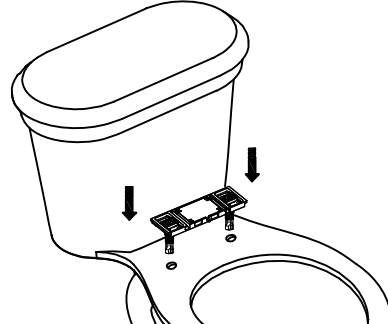

3.Drive the screw, do not fully tighten for further adjustment.

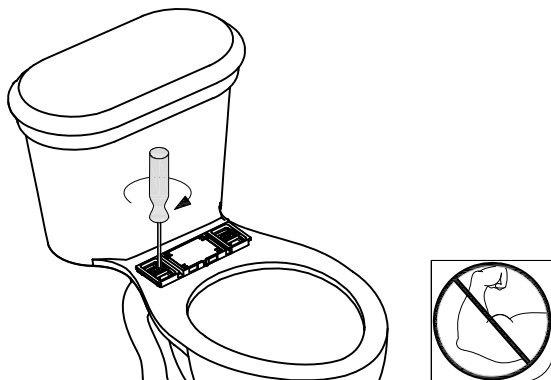

4.Fix the adjustable panel, push the seat to the end.

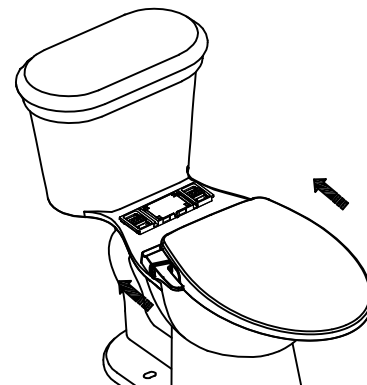

5.Adjust the toilet seat as necessary.

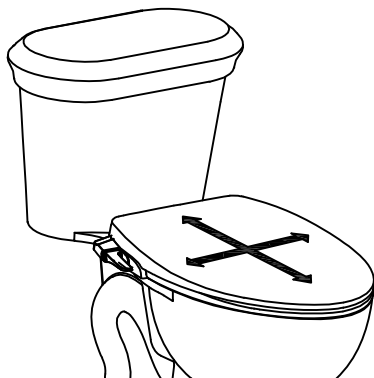

6.Press the button to release the seat.

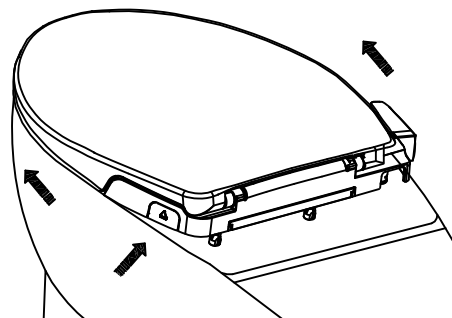

■ Installation Procedure

7. Tighten all screws.



8. Replace seat into position, push it to the end.

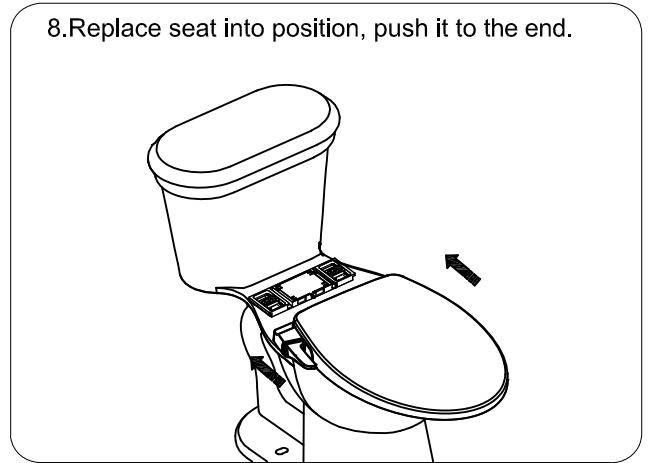

■ Connecting water hose

1. Shutting off the water valve and detach water pipe from the water tank. Connect the T-shaped connector to the water tank and the water valve. Make sure that rubber packing is inserted in between shut-off valve and T-shaped connector.

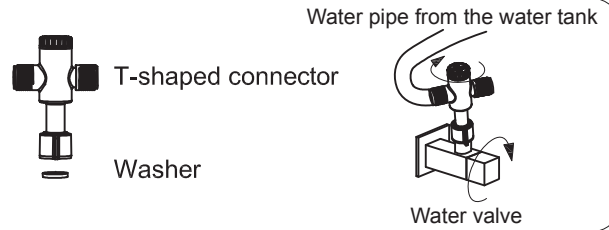

2. Connect the nut of supply hose with T-shaped connector, and fully tighten.

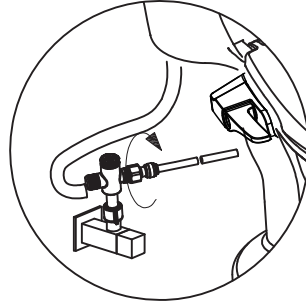

3. Insert the supply hose to the hose connector of seat.

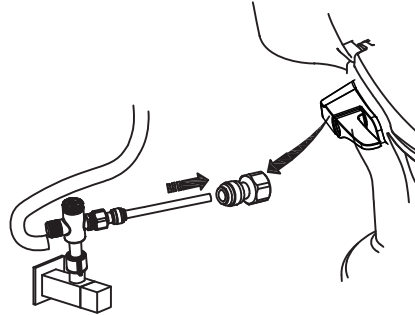

4. Turn on the water valve to check if there is any leakage.

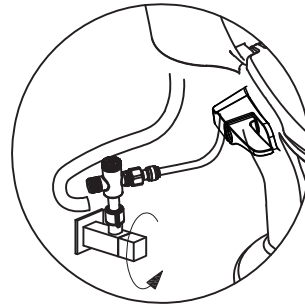

■ Disassembling water hose

1. Press the spring button of the hose connector and pull out the PE hose.

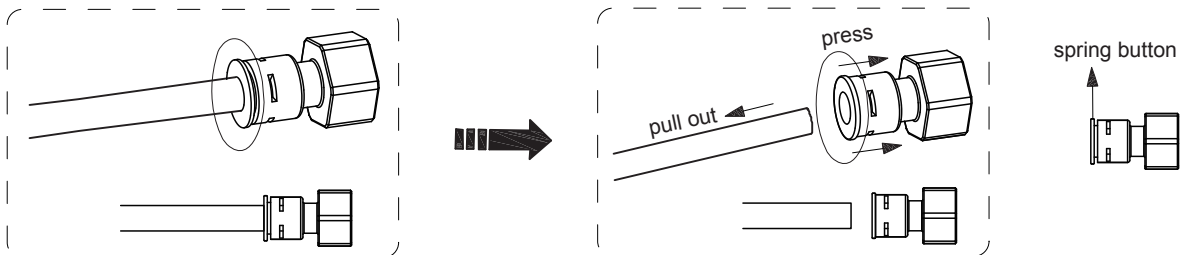

Prohibition

1. Do not lift the product with the seat cover and seat open.
2. Cannot use with the hot water which temperature is higher than 40° C. This may cause a mechanical trouble.

3 Operation

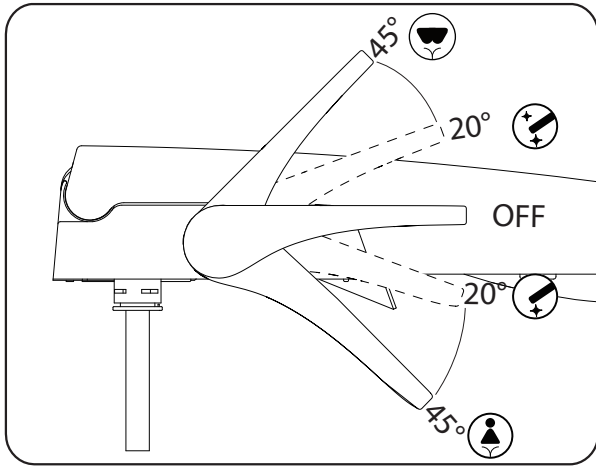

4 gears design.

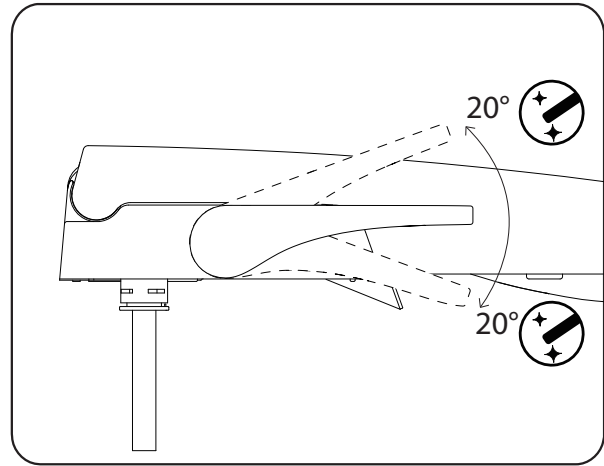

20° upwards or 20° downwards:
for nozzle self-cleaning.

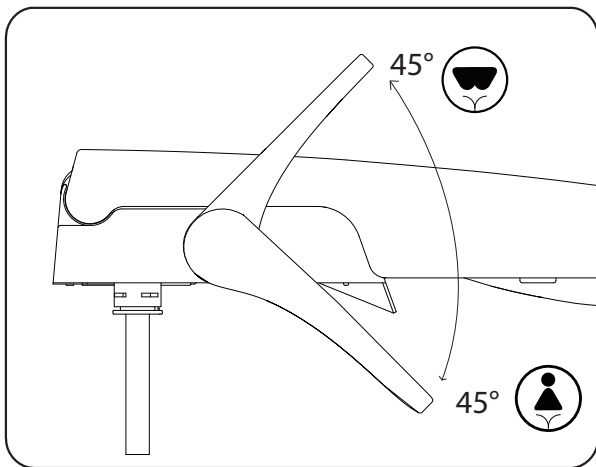

45° upwards -- posterior wash
45° downwards -- feminine wash

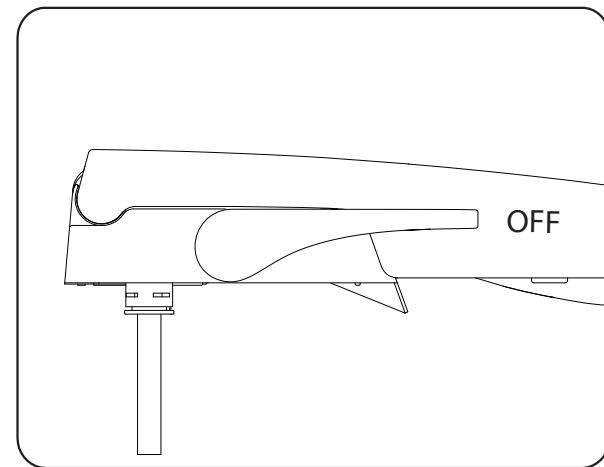

0° -- turn off

4 Clean and dismantlement

1. Clean the outside parts of the product.

Use a smooth sponge/cloth with diluted kitchen detergent to clean the product. Do not use the following methods: hydrogen chloride detergent, painting thinner, benzene, abrasive paper, polishing agent, fragrances and insecticide, etc.

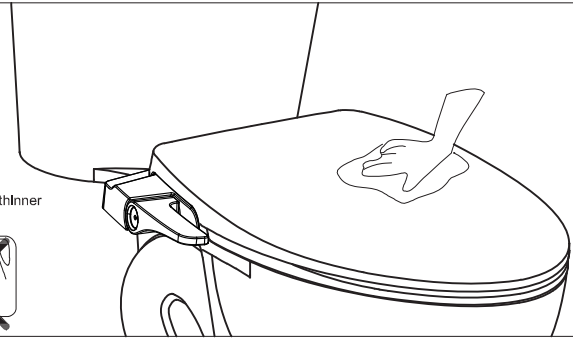
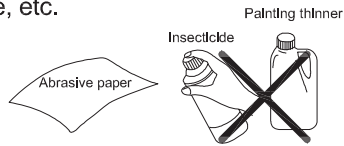

2. Clean the nozzle.

Pull out the nozzle softly and use smooth cloth/sponge or toothbrush with kitchen detergent to clean the nozzle.

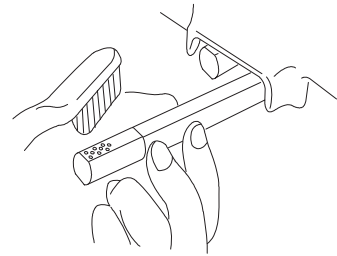

3. Clean the filter.

Clean the filter net of water inlet hose regularly, to avoid water flow is too low. Make sure shutting off the valve before cleaning.

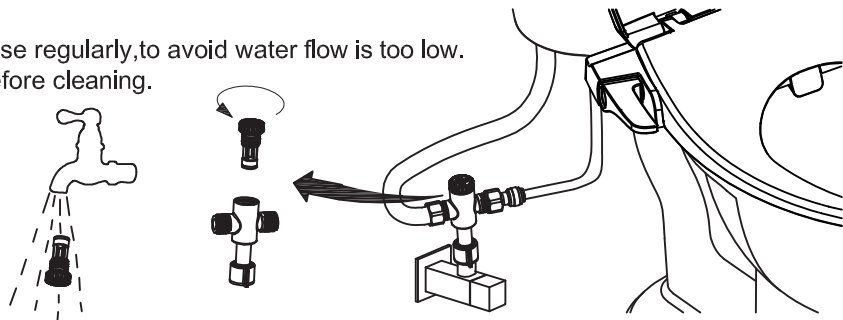

This seat has two quick-release functions:

Seat & Cover release: Open the seat & cover to 90° and lift the seat & cover as pic 4;

Whole unit release: Another method is press the button, pull the whole unit forward as pic 5.

4. Seat & Cover release.

Open the seat and cover to 90° and lift the seat & cover upwards to release the main body. After cleaning, insert the seat & cover into the holes perpendicularly to install the seat.

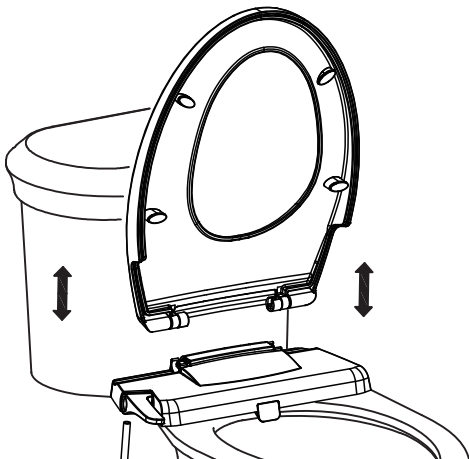

5. Whole unit release.

Press the button, pull the seat forward.

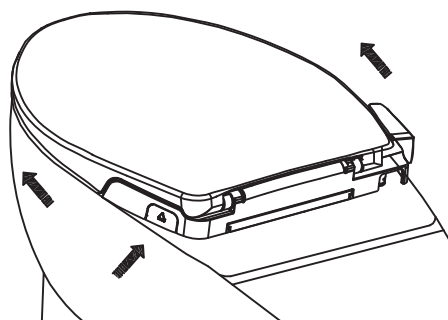

5 Product maintenance

1. Lever replacement.

As per figure A, remove the old lever along the axis direction.

As per figure B, insert the new lever rib into the corresponding control valve slot. The installation is completed with a "click" sound.

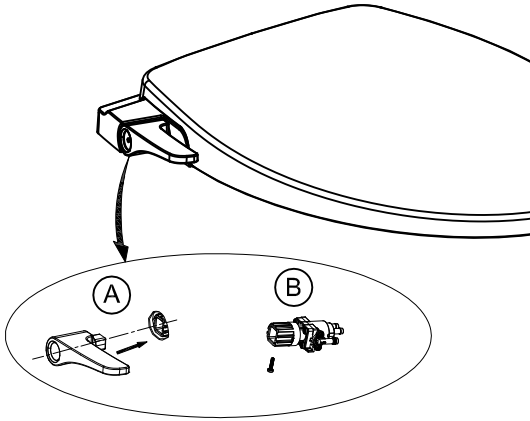

2. Nozzle replacement.

As per figure A, pull out the tube and do not release then remove the old nozzle along the axis direction as per figure B, insert the new nozzle into the tube along the corresponding slot. The nozzle replacement is completed.

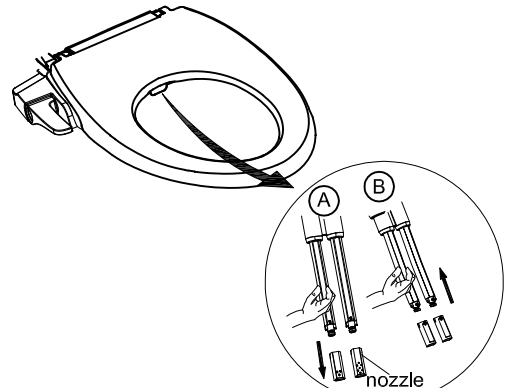

3. Water hose leakage solution.

If water leaked from the water hose, re-tighten the nuts to avoid water leakage.

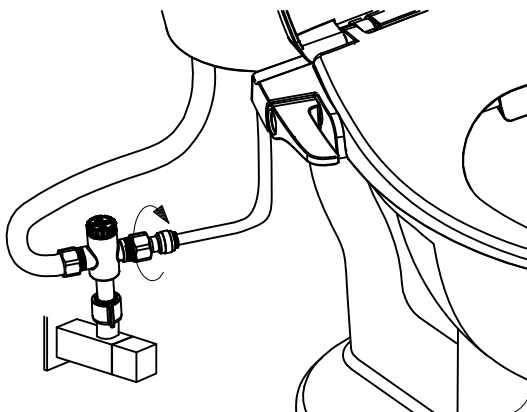

6 Self Diagnosis and Specifications

Self Diagnosis and Trouble shooting

Status	Cause	Solution
Water flow is too low during WASH/BIDET	1.Low water pressure of the unit	During WASH/BIDET, turn the lever fast to biggest volume
	2.Low water pressure of water supply	When water supply pressure is lower than 0.7kgf/cm ² , contact local department for water pressure question
No water comes out during WASH/BIDET	1. Water shut-off valve is turned off	Turn on the water shut-off valve
	2. Filter net of T-shaped connector is stuck	Clean the filter net of T-shaped connector
	3. Nozzle head is stuck	Take off and clean the nozzle head.
	4. External water pressure is low	Increase external water pressure.
Water dropping from bowl when using the unit	External water pressure is too hight	The maximum water pressure of the unit is 0.8MPa . If water supply pressure is higher than that, please contact local department for water pressure question.

If any failure still occurs after above trouble-shooting, please contact local service.



Do not disassemble, repair or remodel the unit.

Specifications

Classification	Description
Model No.	A650
WASH water flow	0.4 - 1.8 L/min
BIDET water flow	0.4 - 1.8 L/min
Backflow Prevention	Backflow Prevention
Water Supply	Direct from water pipes
Water Pressure Range	Static pressure:0.07- 0.6 MPa,Dynamic pressure:above 0.05MPa
Dimensions	490X405X55mm
Weight	2.1 KG

To request service:

- 1.Please recheck the user's manual.
- 2.If failure or damage occurs after refering the manual,stop using the product and contact the retailer or local service center.

Warranty Card

Dear Customer,

Thank you for choosing the product! If failure or damage occurs, please check the product based on the trouble shooting guide in this manual first. If the failure/damage could not be fixed, please contact the retailer or local service center with proof of purchase.

A. Related Info:

Customer	Name:		
	Address:		
	Tel.:		
Retailer	Name:		
	Tel.:		
Model No.		Series No.	
Date of Purchase		Warranty time	1 Year from the date of purchase

B. Notes about the warranty card:

1. Please make sure that the above info is completed in the warranty.
2. This warranty and invoice are important documents for product maintenance. During warranty period, when the retailer or service people come for product maintenance, please present the Warranty and invoice.
3. This warranty cannot be reissued. Keep it in a proper place.

C. Free repairment policy:

During warranty period, if product failure/damage occurs under normal operation according to the user manual, free repair service will be provided.

D. The following repairment or maintenance should be paid:

1. Failure occurs out warranty period;
2. If this warranty/invoice is not presented;
3. Failure/damage occurs due to transportation/collision of the product after purchase;
4. Failure/damage occurs due to natural disasters such as fire, earthquake, flood damage, lightning or by environmental pollution, gas and abnormal voltage;
5. Failure/damage due to user's responsibility, improper repairment or reassembling of the product;
6. Failure/damage due to improper cleaning for product (e.g. improper use of detergent or cleaning method);
7. Failure/damage due to sand, junk or other unexpected goods from water supply;
8. Relocation of the product up to end user's requirement.