

处理器说明

- 格美系列为强大的性能和可靠的功能而构建
- VORTEXM™ 电机具有强大的研磨能力，可消除顽固的厨余碎屑
- VORTEXTM™ 电机采用永磁电机技术，有助于减少堵塞
- 预装电源线-与必须单独购买电源线的型号相比，节省了成本，电源线可轻松拆卸以进行可选的接线
- SoundSHIELD™隔音技术
- 紧凑的设计释放了水槽下的空间
- 不锈钢研磨部件适应连续投料
- 手动复位按钮
- 具备电磁兼容性能
- 垃圾处理减少了被送往垃圾填埋场的垃圾，使之成为您家的环保选择

包含的组件

- 处理器，带通用高强度塑料支架
- 预装电源线，支持硬线
- 可拆卸防溅罩
- 抛光不锈钢水槽法兰和塑料长柄水塞
- 排水弯头和安装组件

维修和保障

- 5年上门服务
- 可与适当尺寸的排污系统安全使用

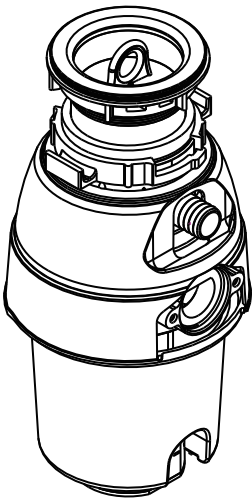

摩恩垃圾处理器

型号: GD5152



主要尺寸

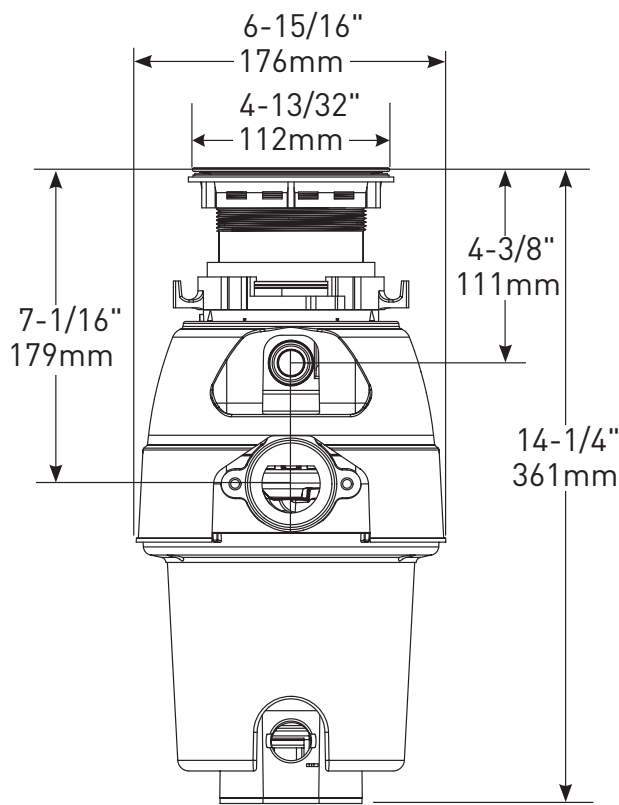

规格说明

功率	GD5152(550W)
投料类型	连续
开/关 控制	空气开关/无线开关（可选配）
电机类型	永磁电机
转速（每分钟转速）	2600
重量	9.24 lbs./4.2 kg
电压	220
频率/电流	50/2.25
排水管连接尺寸	G1 ½ (D40)与G2 (D50)
洗碗机连接尺寸	7/8" / 22mm
最大下沉厚度	1/2" / 13mm
水槽法兰表面处理	抛光不锈钢
研磨组件材料	不锈钢
研磨腔材料	防腐玻璃填充聚酯和尼龙

Disposal Description

- Gourmet Series is built for powerful performance and dependable functionality
- VORTEXM™ Motor has powerful grinding capabilities to eliminate tough kitchen scraps
- VORTEXT Motor features permanent magnet motor technology designed to help reduce jamming
- EZ Mount twist-and-lock sink flange for fast and easy installation
- Pre-installed power cord - a saving over models where cord must be purchased separately, cord easily removes for optional hardwiring
- SoundSHIELD™ sound deadening insulation
- Compact design frees up space under the sink
- Continuous feed with Stainless steel grind components
- Manual Reset Button
- Has EMC performance
- Garbage disposals reduce waste sent to landfills making it an eco-friendly option for your home

Included Components

- Disposal Unit With Universal High-strength Plastic Bracket
- Pre-installed Power Cord, Hardwire Capable
- Removable Splash Guard
- Polished Stainless Steel Sink Flange and Plastic Long Handle Drain Stopper
- Drain Elbow and Mounting Assembly

Warranty & Assurance

- 5-year limited warranty with in-home service
- Safe for use with properly sized septic systems

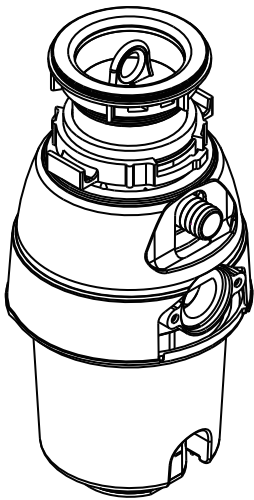

Moen Garbage Disposal

MODELS: GD5152



Critical Dimensions

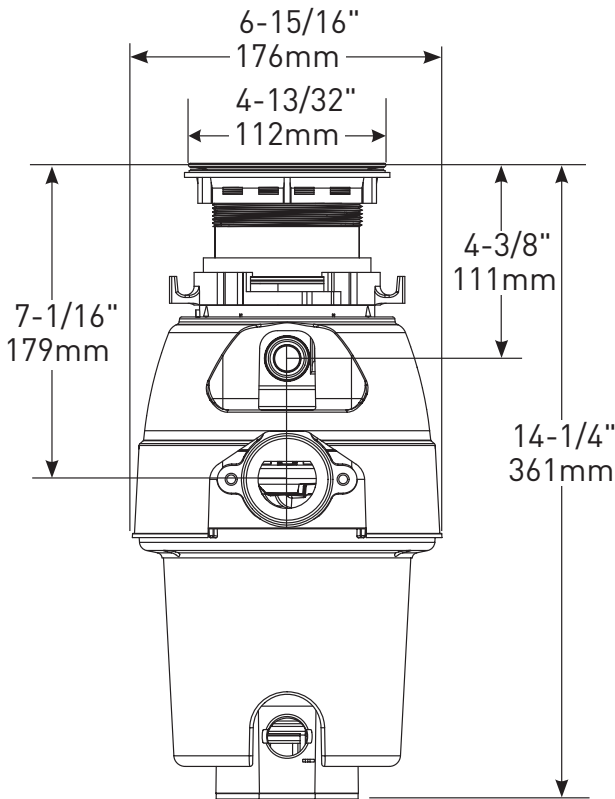

Specification Detail	
Horsepower	GD5152(550W)
Feed Type	Continuous
On/Off Controls	Air Switch/Remote Switch (Optional)
Motor Type	Permanent Magnet Motor
RPM (Revolutions Per Minute)	2600
Weight	9.24 lbs./4.2 kg
Volts	220
Hz/Amps	50/2.25
Drain Connection Size	G1 ½ (D40) and G2 (D50)
Dishwasher Connection Size	7/8" / 22mm
Maximum Sink Thickness	1/2" / 13mm
Sink Drain Range Finish	Polished Stainless Steel
Grind Component Material	Stainless Steel
Grind Chamber Material	Corrosion Proof Glass filled Polyester and Nylon