

MOEN® 摩恩

入墙式花洒通用预埋盒

安装说明书

Universal In-Wall Shower Rough-In Box

INSTALLATION INSTRUCTIONS

如需安装支持，配件丢失或替换等，请联系本公司。
对于中国大陆以外的市场，请咨询当地经销商。
(中国大陆) 400-630-8866
(中国大陆) www.moen.cn
(中国大陆以外) www.moen.com.hk

For installation support, missing or replacing parts, etc., please contact the company. For consumers in markets outside the Chinese mainland, please consult the local dealer.
(Chinese Mainland) 400-630-8866
(Chinese Mainland) www.moen.cn
(Outside Chinese Mainland) www.moen.com.hk

推荐工具

为了安全和让安装和替换变得容易，本公司建议您使用以下工具：

HELPFUL TOOLS

For safety and ease of installation and replacement, the company recommends the use of the following tools:

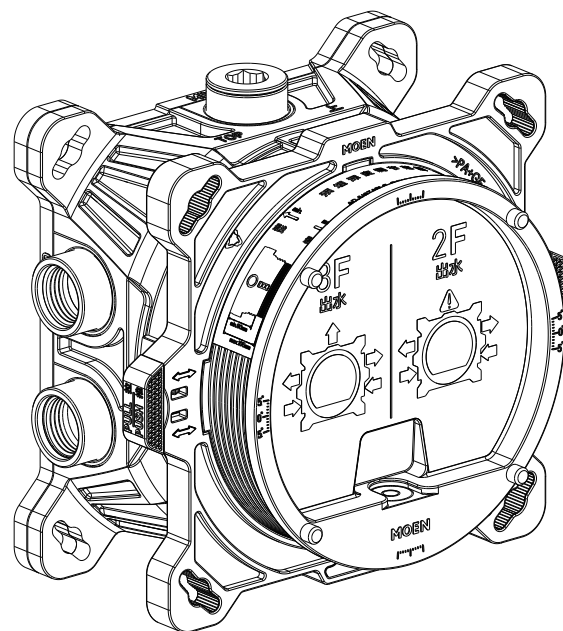
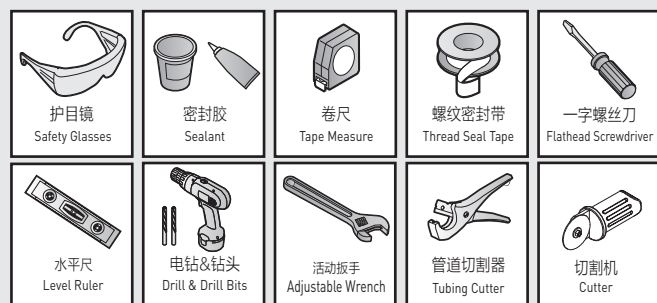

图片仅供参考
(款式因型号而异)

Image is for reference only
(Style varies by model)

记录购买的型号：
(保存安装说明书以备将来参考)

Record Purchased Model Number:
(Save instruction sheet for future reference)

零件清单

- A. 预埋盒主体
- A1. G1/2堵头
- A2. 预埋盒保护盖
- A3. 空心墙安装板
- B. M6x60mm 膨胀螺栓 (x4)
- C. M6x35mm 自攻螺丝 (x8)
- D. 塑料膨胀管 (x8)
- E. 4mm内六角扳手
- F. 无纺布

Parts List

- A. Rough-In Box
- A1. G1/2 Plug
- A2. Rough-In Box Cover
- A3. Hollow Wall Mounting Plate
- B. M6x60mm Self-tapping Screw (x4)
- C. M6x35mm Self-tapping Screw (x8)
- D. Plastic Expansion Tube (x8)
- E. 4mm Allen Key
- F. Non-woven Fabric

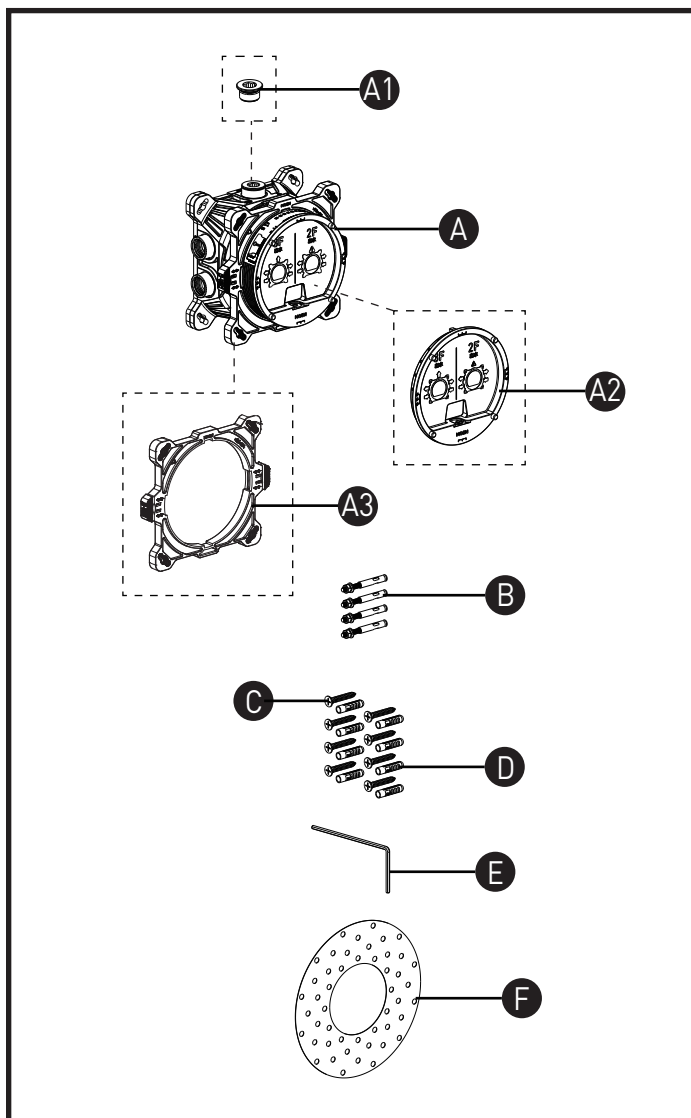

技术参数 Technical Data

Units: mm

供水压力及温度要求:

1. 理想工作压力: 0.1~0.5Mpa
2. 进水温度:
冷水: 4~29℃
热水: 55~85℃
热水建议使用温度: 55~65
3. 供水压力差:
冷热供水压力差不大于0.2Mpa,
压力过低, 可能导致出水温度不稳定。
4. 连接管 G1/2: 左热右冷; 中心距为46mm

Water Pressure and Temperature Requirements:

1. Ideal Operating Pressure: 0.1-0.5MPa
2. Inlet Temperatures:
Cold Water: 4-29°C
Hot Water: 55-85°C
Recommended Usage Temperature: 55-65°C
3. Pressure Differential:
The pressure differential between hot and cold water should not exceed 0.2 MPa. Low pressure may result in unstable outlet water temperature.
4. Inlet connections G1/2: Left for Hot, Right for Cold. Centre distance: 46mm.

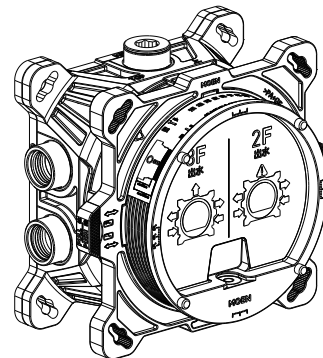
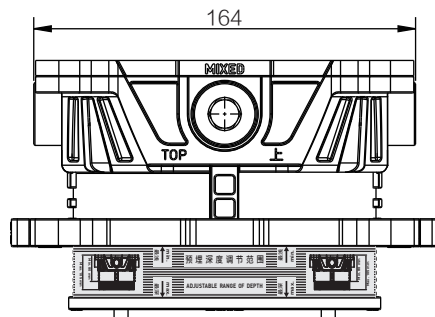
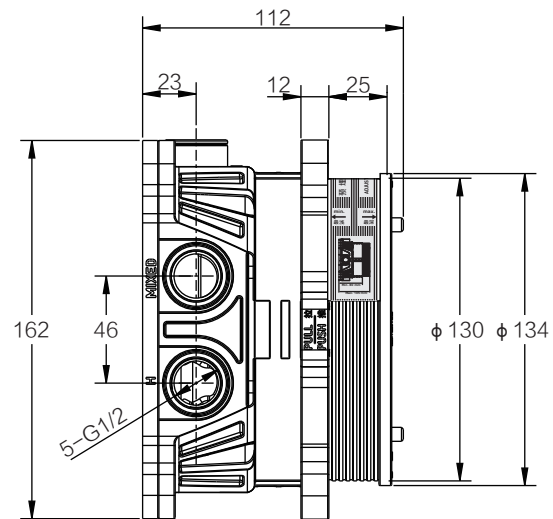
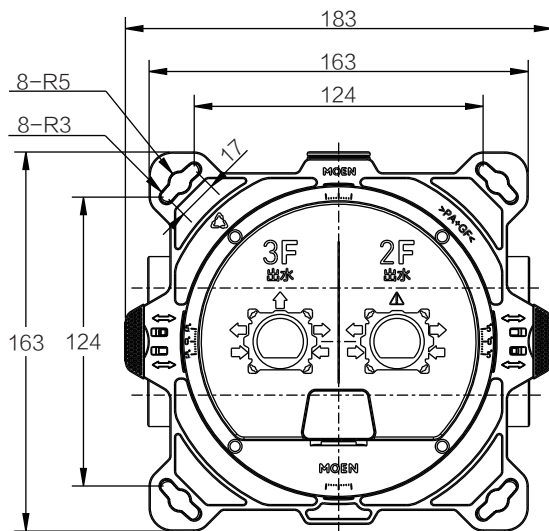

安装说明 Installation Instructions

一. 安装预埋盒 Rough-In Box Installation

安装方式A: 实心墙安装 Installation Method A: Solid Wall Mounting

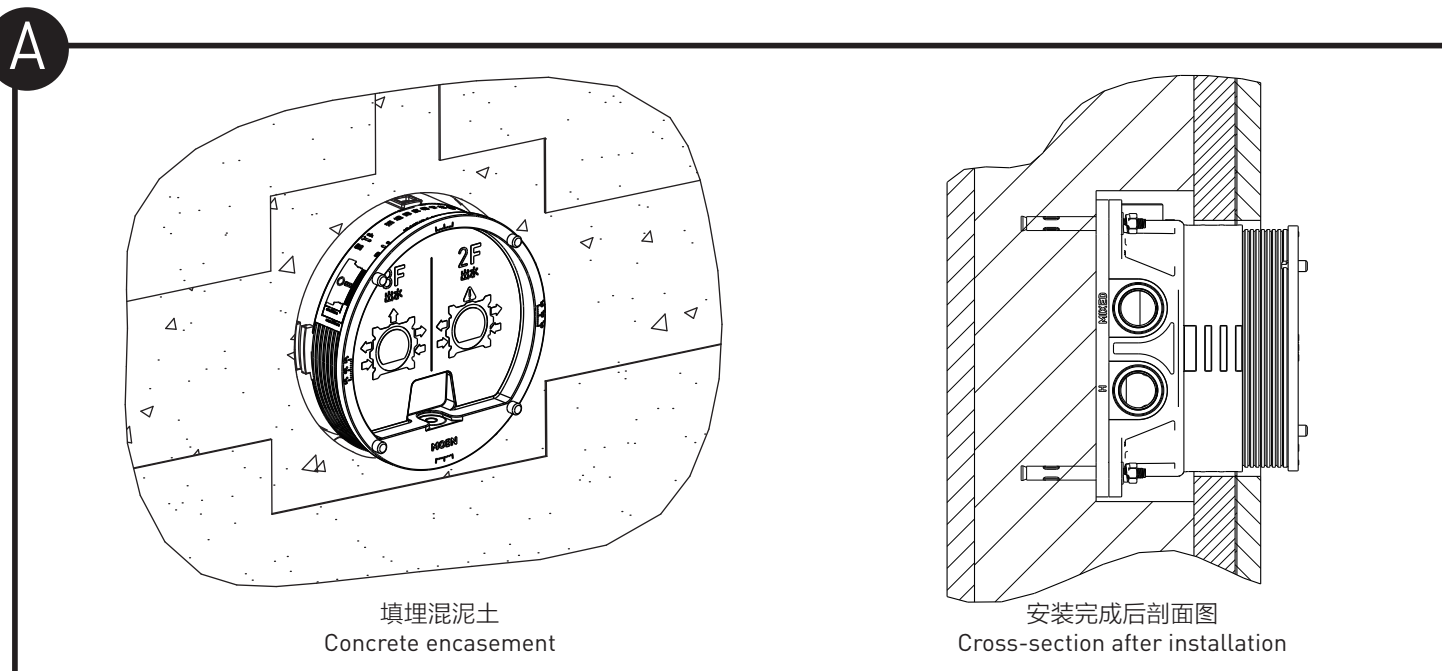

安装方式B: 空心墙安装 Installation Method B: Hollow Wall Mounting

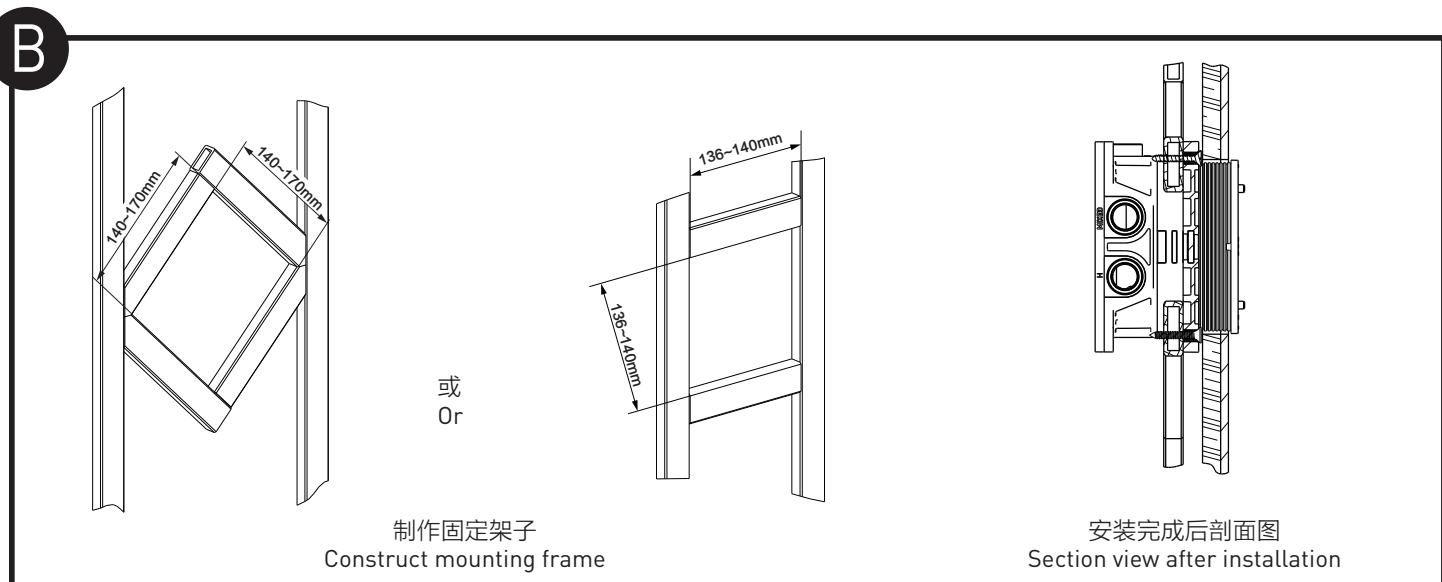

安装方式A：实心墙安装 Installation Method A: Solid Wall Mounting

① 开槽 Grooving

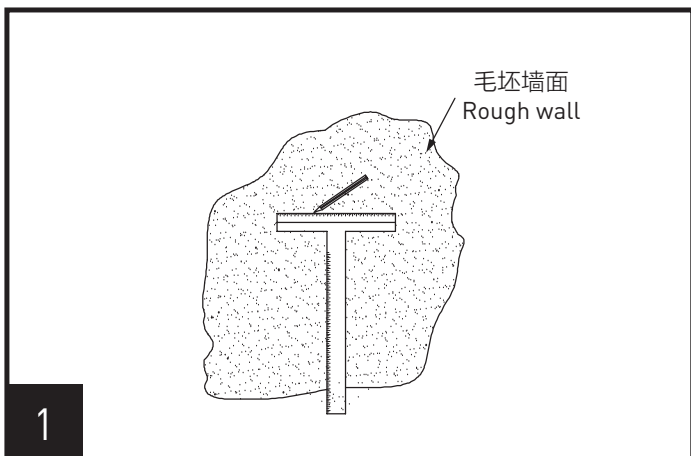

在毛坯墙上标定安装固定预埋盒的位置。

Mark the rough-in box body mounting position on the unfinished wall.

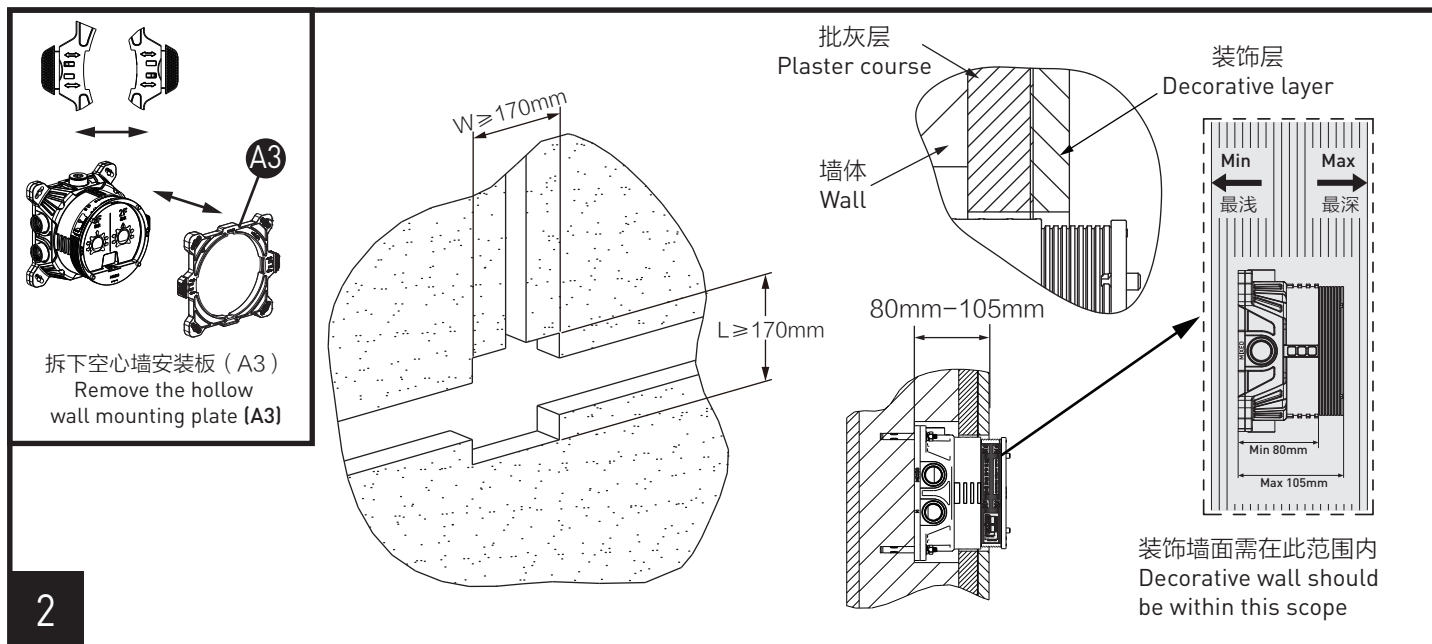

用切割机在墙上开槽，尺寸参考如图。

Use a cutter to groove the wall according to the dimensions specified above.

② 固定预埋盒 Fixing the rough-in box

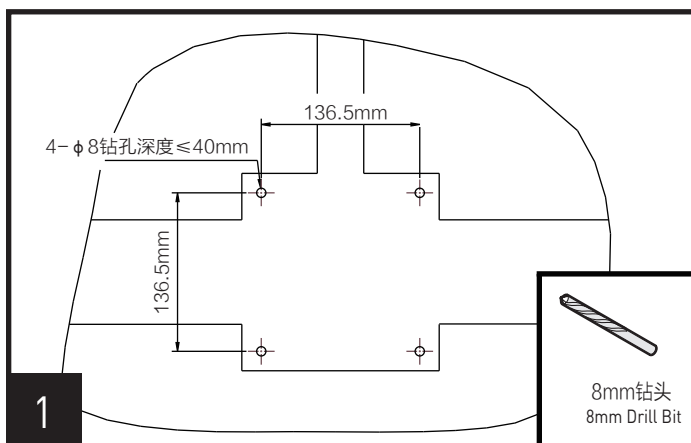

用记号笔画出四个孔的位置，并用电钻打出四个深度约40mm φ8的孔。

Mark the positions of the four holes with a marker. Using a drill, create four holes with a diameter of 8mm and a depth of approximately 40mm.

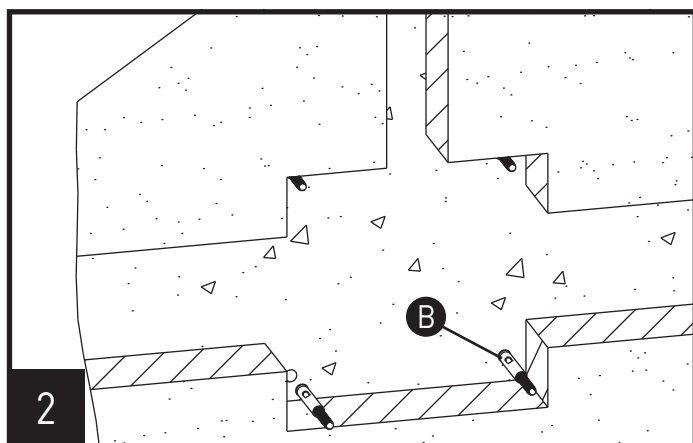

装上四颗膨胀螺栓 (B) 拧紧。

Insert and tighten the four expansion bolts [B].

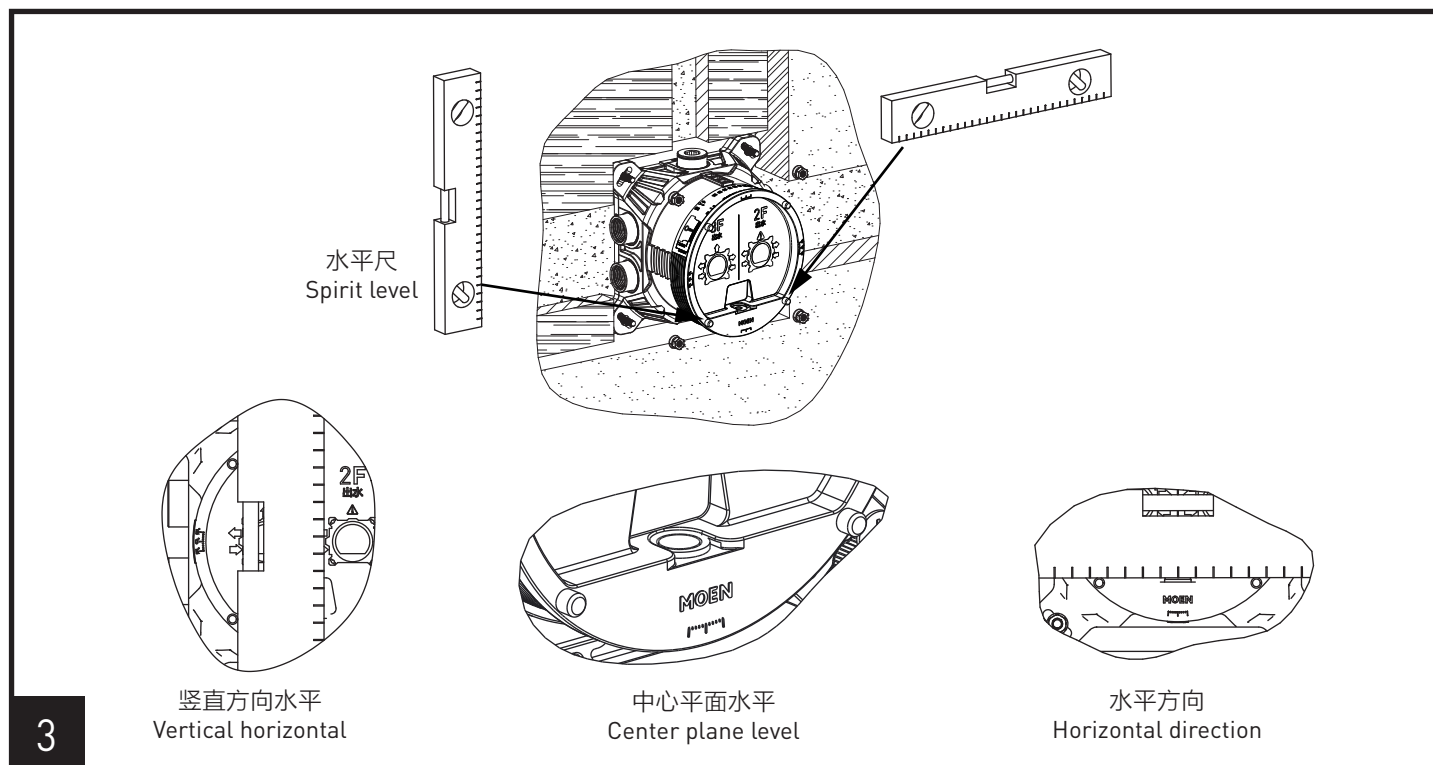

对准孔位放上预埋盒，调整水平并拧紧螺母。

Position the rough-in box, ensuring it is level, and tighten the nuts.

③ 连接管路 Connecting pipe

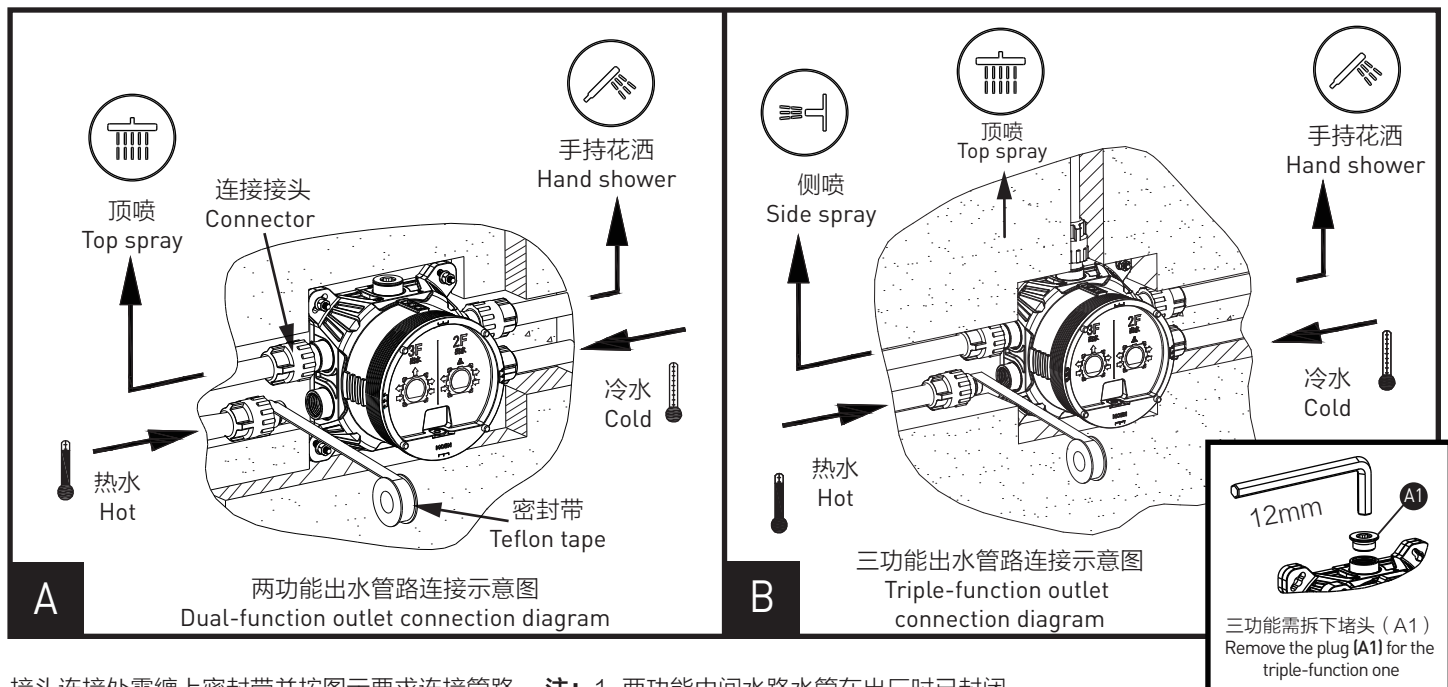

接头连接处需缠上密封带并按图示要求连接管路。注：1. 两功能中间水路水管在出厂时已封闭；
2. 水管与预埋盒的连接接头需另行购买。

Wrap Teflon tape around all threaded connections and connect the pipes as shown in the diagram.

Note: 1. The water pipe for the dual-function middle waterway is sealed at the factory.

2. Pipes and connectors for the rough-in box are sold separately.

④ 检查及测试 Inspection and testing

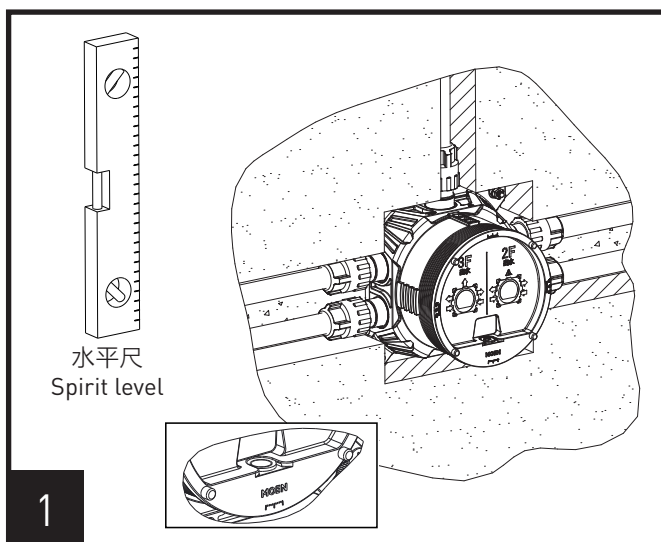

再次检查管路连接及预埋盒水平与深度是否安装正确。

Recheck pipe connections, and ensure that the rough-in box is level and at the correct depth.

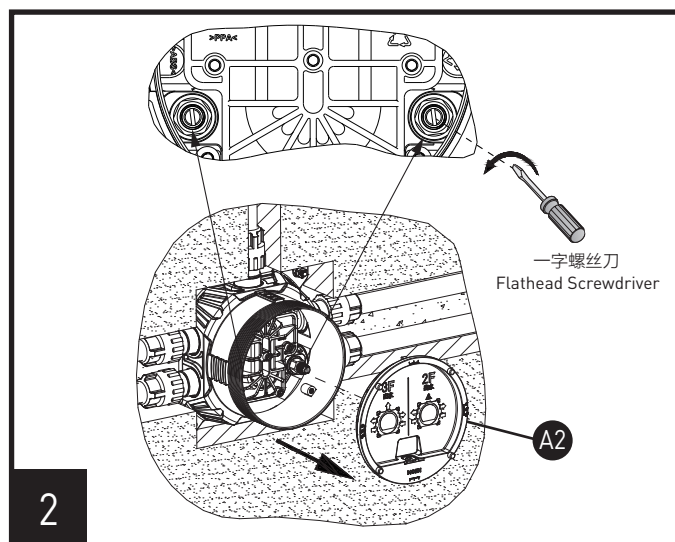

取下预埋盒保护盖 (A2) 对管路进行密封测试。开启总阀后逆时针打开两个止逆阀通入水压，压力值范围为0.8~2.5MPa，建议1.2MPa。观察阀体内部，保持稳定压力1~3分钟，无漏水现象后再顺时针关闭两个止逆阀，盖上保护盖。

To perform the leakage test for piping, remove the rough-in box cover [A2]. Turn on the main water supply, and open both check valves counter-clockwise to introduce water pressure, with a pressure range of 0.8 to 2.5MPa. Recommended pressure: 1.2MPa. Keep a stable pressure for 1 to 3 minutes, observe the inside of the valve body. If there is no leakage, clockwise close the two check valves and replace the protective cover.

⑤ 填埋 Filling

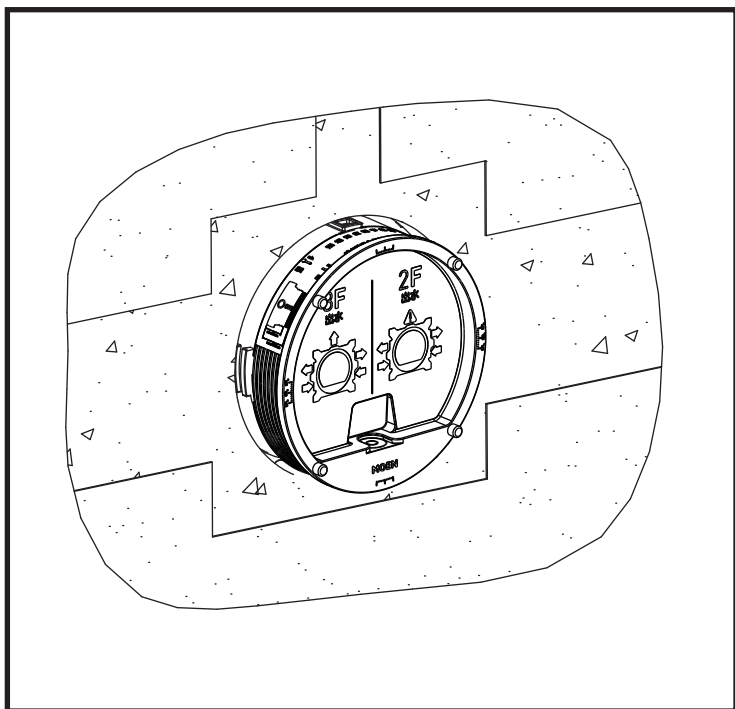

填充壳体周围空隙至平齐毛坯墙面。

Fill the void around the shell until it is flush with the rough wall surface.

安装方式B：空心墙安装 Installation Method B: Hollow Wall Mounting

① 调节空心墙安装板 Adjusting the hollow wall mounting plate

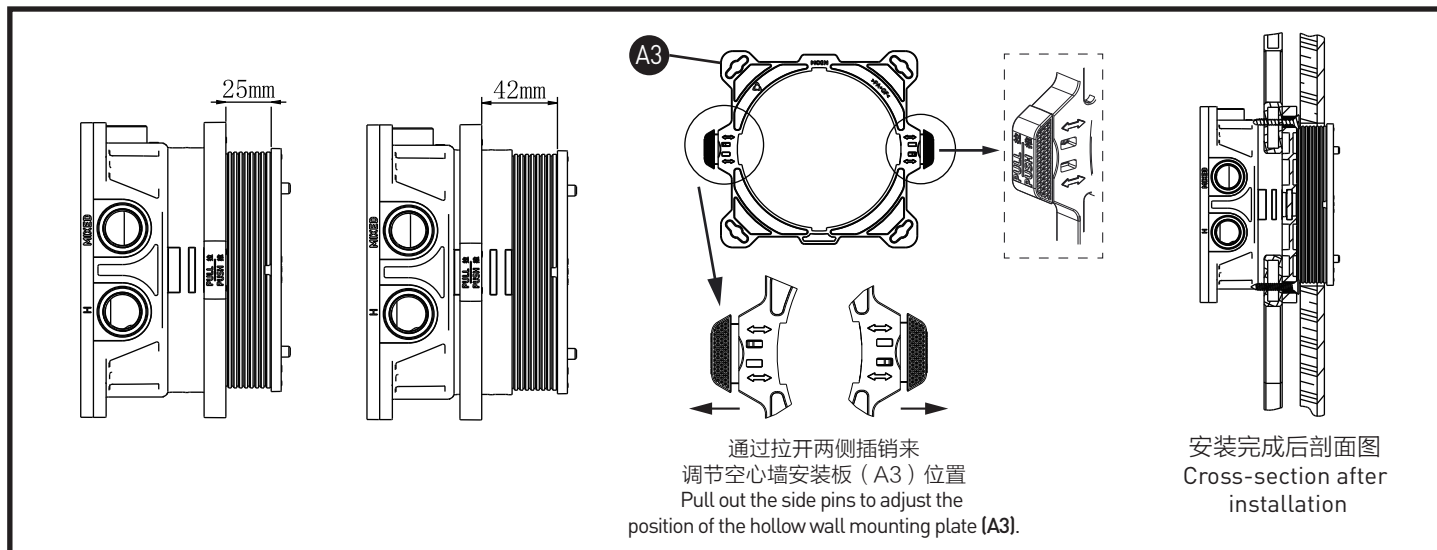

根据不同空心墙厚度，调整好空心墙安装板 (A3) 的距离，如图 (25mm~42mm)。

Adjust the hollow wall mounting plate (A3) distance according to the specific thickness of the hollow wall. See the Figure. [25mm~42mm]

② 制作安装支架 Making mounting brackets

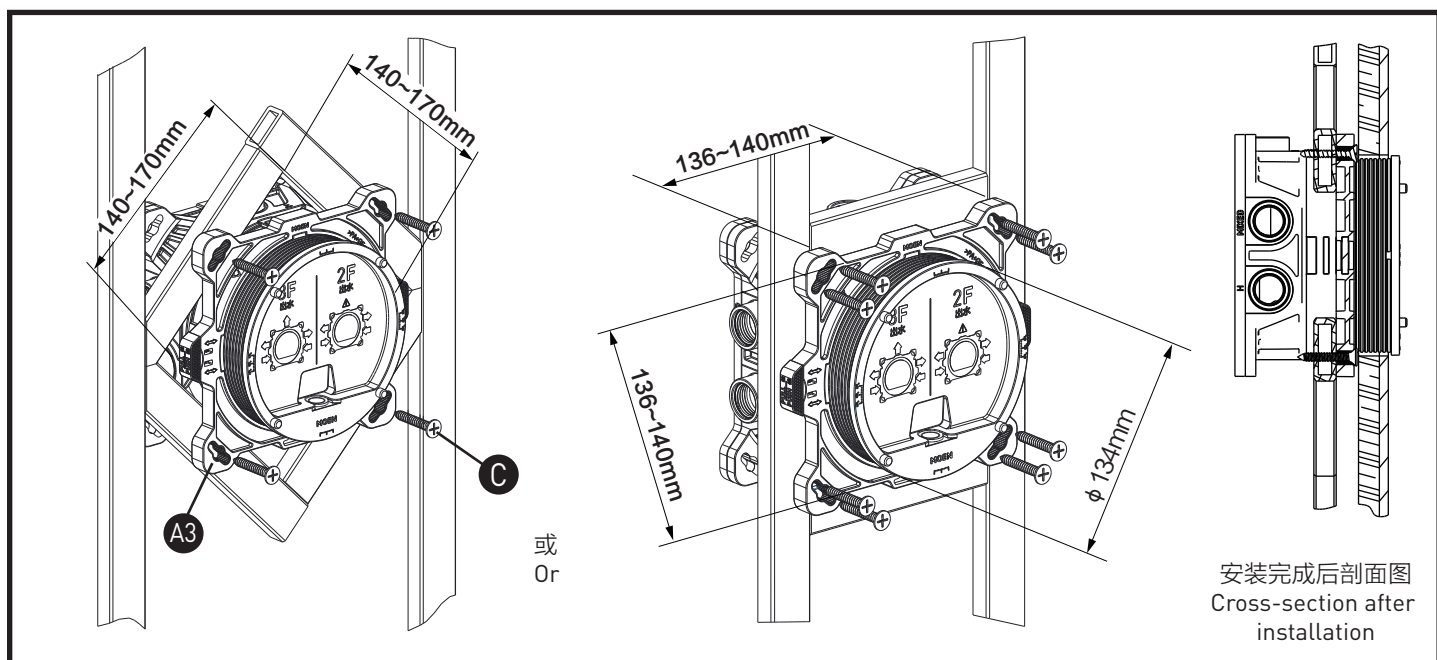

如图制作固定架，并用自攻螺丝 (C) 通过空心墙安装板 (A3) 将预埋盒固定在架子上。

Make a mounting bracket as shown above, and secure the rough-in box to the bracket with self-tapping screws (C) through the hollow wall mounting plate (A3).

③ 连接管路 Connecting pipe

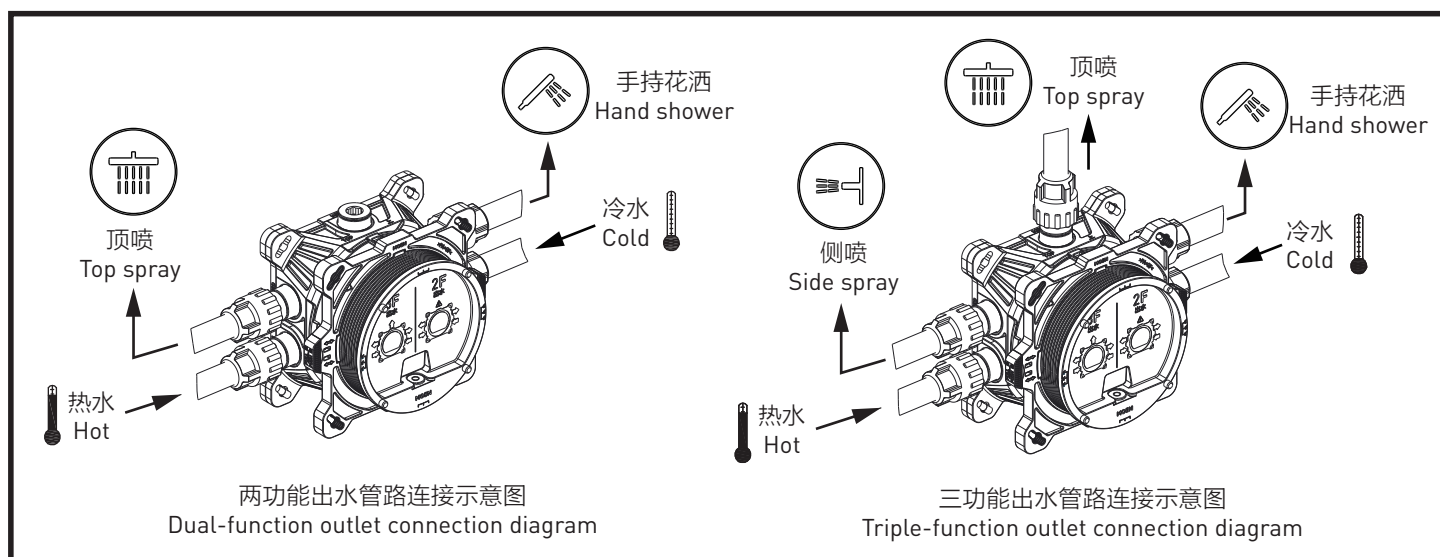

空心墙的出水管路连接方式以及管路检查测试方式与实心墙的方式内容一致，参见第7页。

The connection method of the water outlet piping for the hollow wall and the piping inspection test method are consistent with the content for the solid wall section. For details, see page 7.

二. 安装装饰砖 Installing decorative tiles

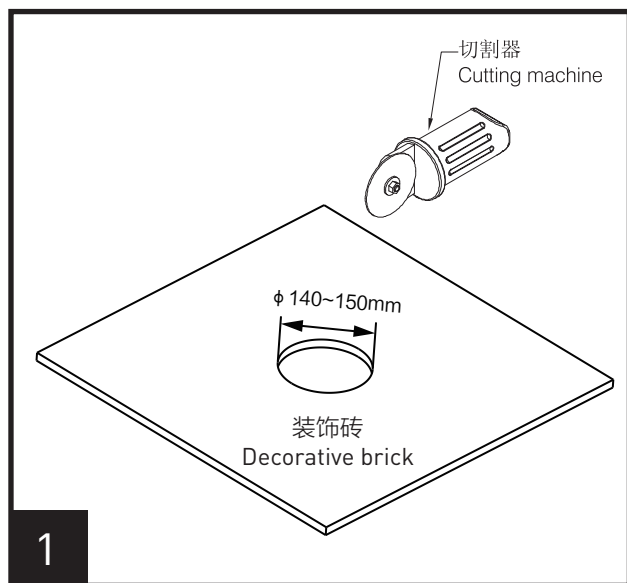

按照图示尺寸在装饰砖上开孔。

Cut out holes in the decorative tile to the dimensions shown in the diagram.

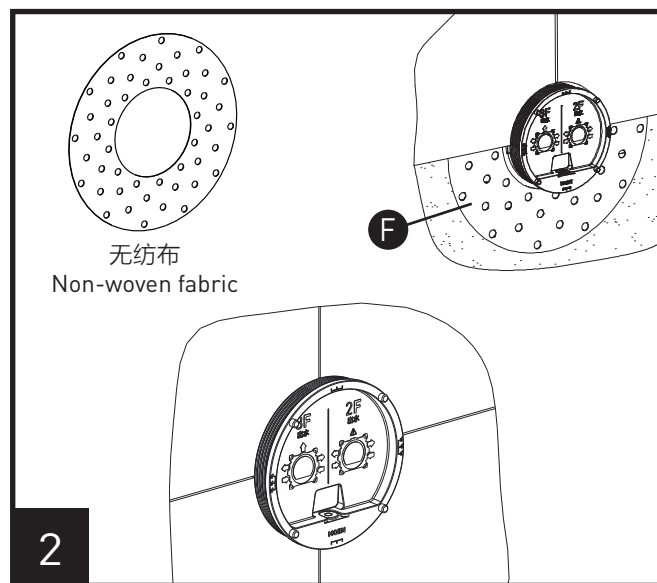

在粘贴瓷砖之前，先在下方铺设一片无纺布（F）。

Apply a non-woven fabric (F) backing pad before attaching the ceramic tile.

至此完成预埋盒的安装。

The installation for rough-in box is complete.

产品售后保修条款

本产品是在高质量标准及生产工艺下制造的，本公司承诺为消费者购买的产品提供有期限免费保修及终身维修服务。龙头免费保修期为：阀芯5年，电磁阀感应器2年，其它附件如淋浴杆、软管、花洒、落水、把手、装饰盖、提拉杆、混水器等保修期均为2年有限。均自消费者购买日（以本产品分销商开具的发票或收据上载明日期为准）起计。

免费保修范围为产品及产品配件（如淋浴杆、软管、花洒、落水、把手、装饰盖、提拉杆、混水器等）由于材质及工艺原因而造成的故障或损坏。免费保修期内，我们将无偿为您提供修理服务及更换发生故障的产品或产品配件。本公司的售后服务责任仅限于对故障产品的修理，而不延及您因产品故障而发生的其他损失，法律另有规定的除外。

您需了解：产品外观碰伤、刻划痕迹，以及滥用及不正当保养所导致的故障或损坏，均不属于免费保修范围。即使在免费保修期内，属下列（1）-（5）情况之一的，需酌情收取修理费用：

1. 不能出示相符的保修卡和有效购买凭证情况的；
2. 未按使用说明告知的使用方法和注意事项造成的故障；
3. 自行拆卸、维修、改装所造成的故障和损坏；
4. 由于不可抗力等外部原因引起的故障和损坏；
5. 由于运输、搬运、挤压等造成的损坏。

对于保修期外或不在保修范围内的产品，如需维修，本公司将酌情收取上门费、人工费及材料费。

本保修条款仅对原始消费者和酒店行业的购买者有效，并不适用于本产品工业、商业、贸易和非酒店行业的使用。

如对本保修条款内容有任何疑问，请拨打400 630 8866 咨询热线，或向当地分销商咨询。对于中国大陆以外的市场，此产品的保修及保障服务详情请咨询当地经销商。

本公司对本产品保修拥有最终解释权。

PRODUCT LIMITED WARRANTY

We offer limited warranty and lifetime maintenance for the products, which are all manufactured with high standards of workmanship.

The period of warranty shall start from the date of purchase of the product (according to the invoice or receipt issued by the company distributors) and shall cover a period of the following: the warranty period for cartridge is 5 years, the warranty period for solenoid valve sensor is 2 years, the warranty period of other accessories such as shower bar, hose, shower, drain assembly, handle, cover, lift rod, aerator etc. is 2 year. This warranty is your coverage against material and workmanship malfunction or defects in the products or components (such as shower bar, hose, shower, drain assembly, handle, cover, lift rod, aerator etc.). During the warranty period, we offer free maintenance and changing of malfunctioned products or product components. The company's after sales service liability is limited to the maintenance of faulty items and does not cover your other losses caused by product malfunction, except for otherwise stipulated by law.

Cosmetic damages (scratches, dents, etc.) and malfunction or defects caused by abuse or improper maintenance is not covered by this warranty. Although the warranty period remains valid, in case of the following conditions (1) - (5), the maintenance cost (material cost and labor cost) shall still be charged as the case may be:

1. Corresponding warranty card and valid invoice cannot be presented;
2. Faults were caused by the incompliance with the instructions and precautions provided in the user's manual;
3. Damages and faults were caused by self-actuated dismantling, repair and refit;
4. Faults and damages were caused by external factors such as force majeure;
5. Damages were caused by transportation, unloading and extrusion, etc.

This warranty is valid for the original consumers only (including hotel use), and excludes industrial and commercial use of the product (except for hotel use). This card is only responsible for product maintenance rather than any other liabilities.

In the event that the product requires maintenance but exceeds the warranty period, or that the product is not covered by this warranty, labor cost and material cost shall be charged as the case may be.

Please call 400-630-8866 or contact local dealer for any question. For markets exclude Chinese mainland, the terms and conditions of warranty shall differ between product categories and countries. Please refer to warranty stated by local distribution.

The company Incorporated shall have the final interpretation of the product warranties.

MOEN® 摩恩

合格证 Compliance Certification

产品名称
Product Name

检验员
Inspector

生产日期
Date of Production

入墙式花洒通用预埋盒
Universal In-Wall Shower
Rough-In Box

富俊汇赢科技（上海）有限公司
中国（上海）自由贸易试验区新杨公路
1800弄1号4幢207室
邮编：201413

Fortune Brands Innovations (Shanghai) Co., Ltd
Room 207, Building 4, No. 1, Lane 1800, Xinyang Highway,
China (Shanghai) Pilot Free Trade Zone