



**Application Guide**  
**Bell Press Switch**

**CAT. NO.**  
KB31BPB  
KB31BP  
KB32BP

**Vivace**

Thank you for choosing **Schneider Electric** Vivace Bell Press Switch. Please read the following important information before installation and use.

**This application guide applies to the following Vivace products.**



**Cat No.**

KB31BPB

**Description**

10A 250V Bell Press Switch



KB31BP

10A 250V 1 Gang Press Switch



KB32BP

10A 250V 2 Gang Press Switch

## SPECIFICATIONS

Voltage	: 250VAC
Dimension	: 86mm x 86mm
Mounting Centre	: 60.3mm
Compliance	: IEC60669-1, MS IEC 60669-1, SS227

## IMPORTANT NOTE

Please check your local wiring regulations before installation.

## WIRING DIAGRAMS



## MOUNTING INSTRUCTION

Please refer to the following diagram for proper installation.

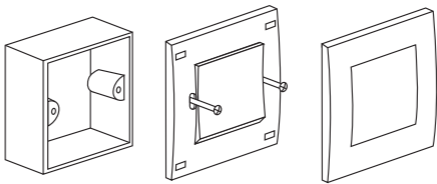

Remarks: For surround mounting, align the clip locks on the faceplate and press firm on the surround. Complete engagement of the clip locks is indicated by a clear "click" sound.

