

Thank you for choosing Schneider Electric™ AvatarOn A series products. To ensure proper application of our product, please read through the following information before installation and use.

This application guide applies to the following products.

(Notes: suffix\_XX//XX/...\_C5/G2... etc. mean the colors and sales areas)

Cat. No.	Description
M3T01WP	Weatherproof Box

## SPECIFICATIONS

Dimension : 143.3 x 101.3 x 27.8 mm

## IMPORTANT NOTE

1. The product must be installed by qualified electricians.
2. Please check your local wiring regulations before installation.
3. Please use the standard wall box.
4. Safekeeping the cover to prevent damage during product installation.
5. Cut off the power supply when cleaning the product. Use a piece of soft and dry cloth to wipe off the dirt and contamination on the surface. Do NOT use corrosive chemicals.
6. Please prevent from contamination and degradation during decoration and renovation.
7. When blank space in grid plate cannot be fully filled in by functional modules, blank cover module must be used to fill in the gap.
8. This box is only suitable for even and flat wall.
9. This box is suitable for devices of AvatorOn A, Concept, S-Flexi, Zencelo A ranges.
10. IP55 protection is only provided when Box cover and hole is fully closed

## MOUNTING INSTRUCTION

Please refer to the following diagram for proper installation.

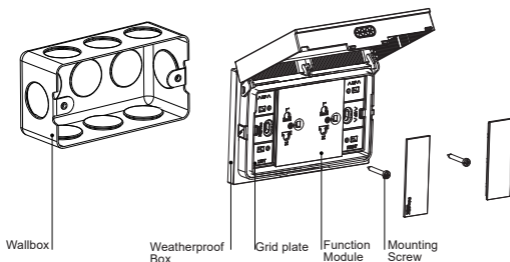

1. Pass wire through weatherproof box grid plate and connect with function module.
2. Install switch/socket module on grid plate, mount it on the wall with weatherproof box and fasten with screws.
3. Close weatherproof box cover to ensure all-round protection. The box is fully closed when hear a 'click'.
4. Inspect the area between the enclosure and wall to ensure there is no gap. If there is any gap from uneven wall surface, it must be sealed.

## UNMOUNTING INSTRUCTION

### 1. For Concept, S-Flexi, Zencelo-A range

1.1 Unsheathe the seal cap on the side.

1.2 Insert a suitable screwdriver into the hole, and twist the screwdriver to remove the sourround.

1.3 Unmount the screws.

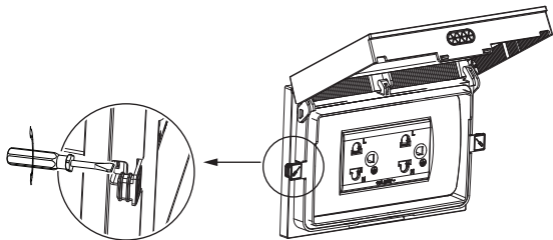

### 2. For AvatarOn A range

2.1 Insert a suitable screwdriver as the below figure, and twist the screwdriver to remove the side cover.

2.2 Unmount the screws.

