

Thank you for choosing **Schneider Electric** AvatarOn series products. To ensure proper application of our product, please read through the following information before installation and use.

### This application guide applies to the following products.

(Notes:suffix\_WE/WG/GH/LW/WD/ST\_G11/G2 etc. mean the colors and sales areas)

Cat. No.	Description
E8331TV	1G TV Socket, 75Ω, Through-Connect
E8332TV	2G TV Socket, 75Ω, Through-Connect
E8331RJS	1G S Keystone Wallplate (w/o Mod)
E8331RJS4	1G Tel Socket, Shuttered Wallplate
E8331RJS5	1G RJ45 Data Cat5E, Shuttered
E8331RJS6	1G RJ45 Data Cat6, Shuttered
E8332RJS6	2G RJ45 Data Cat6, Shuttered
E8332TVFMM	2 Gang TV Master/FM Socket
E8331TVM	1G TV Socket Master, 75Ω, 5-860MHz
E8332RJS	2G S Keystone Wallplate (w/o Mod)
E8332RJS4	2G Tel Socket, Shuttered Wallplate
E8332RJS5	2G RJ45 Data Cat5E, Shuttered
E8332TDRJS5	1G Tel + RJ45 Data Cat5E, Shuttered
E8332TVRJS	2G TV+S Keystone Wallplate (w/o Mod)
E8332TVFRJS5	1G TV-F + RJ45 Data Cat5E, Shuttered
E8332TVRJS5	1G TV+ RJ45 Data Cat5E, Shuttered
E8332TVRJS6	1G TV+ RJ45 Data Cat6, Shuttered

### SPECIFICATIONS

Mounting centre	: 60.3mm
Compliance	: BS5733, IEC60670

### IMPORTANT NOTE

1. The products must be installed by qualified electricians.
2. Please check your local wiring regulations before installation.
3. Please use the standard 86 size wallbox.
4. Safekeeping the cover to prevent damage during product installation.
5. Turn off the power supply when you clean the product. Use a piece of soft, slightly-moistened cloth or tissue paper to wipe off the dust and dirt on the surface. Avoid using corrosive chemicals.

### WIRING DIAGRAMS

Data outlet wiring instructions

#### MODULAR WIRING CONFIGURATION

COLOR CODE	T568B	T568A
White-Blue	5	5
Blue	4	4
White-Orange	1	3
Orange	2	6
White-Green	3	1
Green	6	2
White-brown	7	7
Brown	8	8

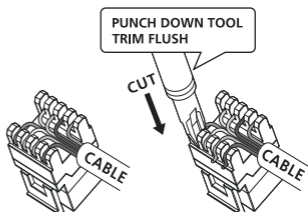

## TV outlet wiring instructions

### 1. Structure of coaxial cable.

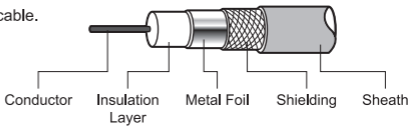

### 2. Cut the sheath of coaxial cable according to the following diagram.

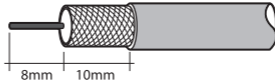

### 3. Loosen screw "A", install the cable to "Input" terminal. The conductor should place firmly on metal grip while the shielding is placed in the cable grip. Install another cable to "Output" terminal by repeating the previous step. Then tighten the screw "A" as shown below.

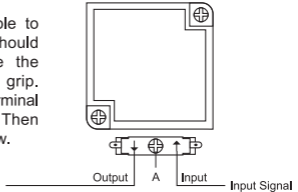

## Tel outlet wiring instructions

1. Cable of different colour must be fixed corresponding.
2. Fix the cable to the position 2,3,4,5 according to the right diagram.

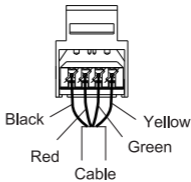

## MOUNTING INSTRUCTION

1. Remove the product cover and safekeeping .
2. Connect the wires to the terminals and tighten the terminal screws.
3. Screw the grid plate onto the wall box.
4. Snap the product cover.

