

Thank you for choosing **Schneider Electric** AvatarOn series products. To ensure proper application of our product, please read through the following information before installation and use.

### **This application guide applies to the following products.**

(Notes: suffix\_WE/WG/GH/LW/WD/ST\_C5/G2 etc. mean the colors and sales areas)

Cat. No.	Description
E8342616USB	16A International Socket with 2.1A USB

### **SPECIFICATIONS**

USB Input Voltage	: 220-250V~
USB Input Frequency	: 50/60 Hz
USB Input Current	: 0.45A
USB Output Voltage	: 5V DC
USB Output Current	: 2.1A max
USB Compliance	: IEC62368-1
USB protection	: Over heat, over current, over voltage
16A socket Voltage	: 250V~
16A socket Current	: 16A
16A socket Compliance	: IEC60884-1 (refer to test report)
Mounting centre	: 60.3mm
Operation Temperature	: -5°C~40°C

### **IMPORTANT NOTE**

- 1 . The products must be installed by qualified electricians
- 2 . Please check your local wiring regulations before installation
- 3 . Suggest to install product with 47mm depth wallbox
- 4 . Suitable for mounting on concrete or other non-combustible surface only
- 5 . Safekeeping the surround to prevent damage during product installation, Don't disassemble the USB module
- 6 . Turn off the power supply when you clean the product. Use a piece of soft cloth or tissue paper to wipe off the dust and dirt on the surface. Avoid using corrosive chemicals
- 7 . Kindly ensure your device's Battery Charging Specification suitable with this USB Charger before charging
- 8 . Do not insert metal objects into USB Charger
- 9 . User will feel some heat at the product surface when charging is in progress
- 10 . Device's charging performance will be impacted by device's charging protocol, quality of charging cable used, and other relevant factors
- 11 . Some charging cables with electronic design might functions as charging device.
- 12 . This permanently connected equipment does not contain internal disconnected device, a readily accessible disconnected device should be provided externally
- 13 . Not advisable to use with multi adaptors
- 14 . Not allow reserve charging
- 15 . Indoor use only

## WIRING DIAGRAMS

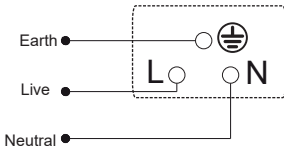

## MOUNTING INSTRUCTION

1. Connect the wires to the terminals (recommend to leave 10-12mm bare metal wire) and tighten the terminal screws.
2. Screw the grid plate onto the wall box.
3. Snap the product cover.

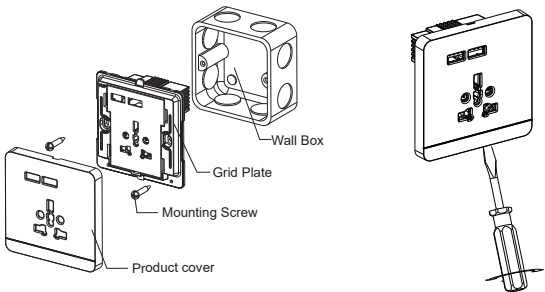

Insert a screwdriver into the clip lock, and twist the screwdriver to remove the product cover.