

Thank you for choosing **Schneider Electric** ZENcelo Unit. To ensure proper application of our product, please read through the following information before installation and use.

This application guide applies to the following products :

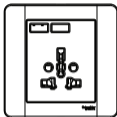

**Cat. No. :**

E8442616USB

**Description :**

16A International Socket with 2.1A  
USB

## SPECIFICATIONS

USB Input Voltage	: 220-250V~
USB Input Frequency	: 50/60 Hz
USB Input Current	: 0.45A
USB Output Voltage	: 5V DC
USB Output Current	: 2.1A max
USB Compliance	: IEC62368-1
USB protection	: Over heat,over current, over voltage
16A socket Voltage	: 250V~
16A socket Current	: 16A
16A socket Compliance	: IEC60884-1 (refer to test report)
Mounting centre	: 60.3mm
Operation Temperature	: -5°C~40°C

**Schneider**  
Electric

## APPLICATION GUIDE

### 16A International Socket with USB

**CAT. NO.**

E8442616USB

MFR8576907 V01

ZENcelo

## IMPORTANT NOTE

1. The products must be installed by qualified electricians
2. Please check your local wiring regulations before installation
3. Suggest to install product with 47mm depth wallbox
4. Suitable for mounting on concrete or other non-combustible surface only
5. Safekeeping the surround to prevent damage during product installation, Don't disassemble the USB module
6. Turn off the power supply when you clean the product. Use a piece of soft cloth or tissue paper to wipe off the dust and dirt on the surface. Avoid using corrosive chemicals
7. Kindly ensure your device's Battery Charging Specification suitable with this USB Charger before charging
8. Do not insert metal objects into USB Charger
9. User will feel some heat at the product surface when charging is in progress
10. Device's charging performance will be impacted by device's charging protocol, quality of charging cable used, and other relevant factors
11. Some charging cables with electronic design might functions as charging device.
12. This permanently connected equipment does not contain internal disconnected device, a readily accessible disconnected device should be provided externally
13. Not advisable to use with multi adaptors
14. Not allow reserve charging
15. Indoor use only

## WIRING DIAGRAMS



## MOUNTING INSTRUCTION

Fixing :

Please refer to the following diagram for proper installation: (Proper wire stripping length: 10-12mm)

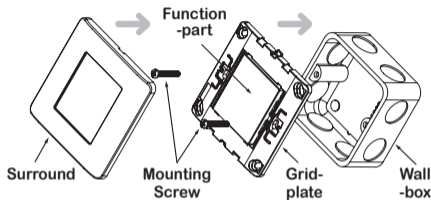

Remarks:

For surround mounting, align the clip locks on the grid plate and press both side of the surround. Complete engagement of the clip locks is indicated by two clear clicks.

Remove :

Insert a screwdriver into the Release-Lock, and twist the screwdriver to remove the Surround

